

SEND & RIPLEY HISTORY SOCIETY

Chairman

Mr K H Bourne
Heath Farm, Tannery Lane
Send, Woking
Phone: Guildford 223028

Secretary & Newsletter Editor

Mr L G Bowerman
The Manor House
Send Marsh, Ripley
Phone: Guildford 224876

Treasurer: Mrs Janet Hill, Asphodel, Milestone Close, Ripley - Gfd 224216

Typed by Chris Parker. Copyright Send & Ripley History Society 1984

Newsletter No 59

November/December 1984

CONTENTS

Page No

Christmas Muffs and Easter Eggs - some reminiscences of social life from the turn of the century in Ripley and elsewhere - Jane Bartlett	2
The Buildings of Hampton Court - notes on a talk by Desmond FitzPatrick - Bob Gale	3
Ripley Bakery, Buildings Group Report on - John Slatford	5
Mediaeval Houses in Suffolk - Bob Gale	6 & 7
Lords and Stewards of the Manor of Papworth (Papercourt) - John Molyneux-Child	Facing 7
Send Tannery, further notes on	7
"Ripley and Send - Then and Now" - launch of book	8
The Almshouse, Including Further References to Ripley Church and Newark Priory - Bette Slatford and Les Bowerman	8
The History of the Evershed Family - notes on talk by John Dendy Evershed - Marie Timmings	10
Secretary's Report	11
Volunteers for Archaeological Work in Surrey	12
Restoration Appeal for St Mary's Church, Send	12
Notice of Annual General Meeting 28 February 1985	12
Forthcoming Events	12
Surrey Local History Council Symposium on "Surrey Churches" - Ken Bourne	13

CHRISTMAS MUFFS AND EASTER EGGS

When, as a child in the thirties,--I used to stay in a gamekeeper's cottage in Cumberland, I was even then fascinated by a different pattern of life. At Easter time, instead of chocolate eggs, we had our breakfast eggs boiled in violets, primroses and ferns, so that each one came out stained with a different floral pattern. The cottage pig was home cured and tasted deliciously of treacle. The sparrow-pie, however, filled me with horror, as I had seen the traps with small finches caught as well. The chief piece of furniture was a "press" with linen and clothes in the drawers below, and cheese, jam and sugar kept in the food cupboard above. One slept on feather "bags" made from the down and feathers saved after plucking; these bags had to be shaken and turned each morning. There was a long journey down the cobbled yard, past the pump, to reach the privy, which was draughtily perched over a running stream - it was a double seater. If the yard was muddy one had to slip one's feet into the thongs of wooden pattens.

Things have changed too from my own home days in Sussex. How many people still pay afternoon calls and leave visiting cards? Mother used to leave one of hers and two of father's, taken out of her mother-of-pearl card case. In the afternoon the maid used to change her dress from brown-and-white to black, with a frilly white apron and a cap with streamers. We, as children, wore underwear called liberty bodices and had leather leggings with rows of awkward buttons. Our bedtime was soothed with the sound of mother playing the piano, and with father singing "Pale hands I love beside the Shalimar". We did have a His Master's Voice gramophone with a trumpet speaker, but that was for special treats, and we were sometimes allowed to clip the wooden needles before we played a record of Caruso or Dame Nelly Melba, recorded on one side only.

While talking to a number of the older residents in Ripley, I have learned a lot about life here at the turn of the century. One person in her nineties used to expect a new muff every Christmas to wear with her large brimmed velour hat. Another person said that when she started work at the age of 15 she always wore skirts down to the ground, trimmed with brush braiding, to stop the wear against the stone floors, and at that age she had to wear corsets, the stays of which were pulled tight either by someone else or by pulling against the bedpost. Even tennis and golf were played with long skirts and full petticoats, and a hat anchored on by a hat pin. The bathing costumes were considered very daring, made of serge and down to the knees with an overskirt, and with a large sailor collar. On the head was a mob cap.

It was small wonder that there were so many laundresses in Ripley, and that several buildings, such as the one behind Cobham Cottages, were laundries. It took about an hour to iron even one petticoat that had goffering, and often three were worn at once. There was a form of washing machine in one of the laundries near Ryde Farm, working rather like a butter churn. One person I know still uses her flat iron, heated on the top of the stove, as she feels more at home with it.

Furniture does not seem to have altered much, but it is interesting how many households had a piano and played it regularly. Someone does remember the draping of the furniture, not only the table but even the mantelpiece had a cloth on it with a fringe of hanging bobbles.

Jobs were different too. An under parlourmaid told me that she had no idea how to cook when she was married because she was never allowed to go into cook's kitchen, but acted as a go-between for the scullery maid and the parlourmaid. One cook-general, when given the menu for the day, was also

given the exact quantities needed, so that no more and no less had to come out of the store cupboard. Her day started at 5 in the morning, as she had to clean the flues and get the range going for hot water.

Even shopping was different. The horse-drawn milk cart came round with milk straight from the cows in churns, to be measured into the household jugs by little hooked measures hanging on the side - measures going down to half a gill. The grocers had to do their own weighing and packaging, the sugar into blue bags, the biscuits out of large tins, and the bacon had to be boned and sliced by hand. Bread at the bakers had to be weighed, and sometimes an extra bit was added or taken away - an incentive for the hungry young to do the errands. On Sundays the baker's oven was used to cook people's joints (I must find out how they knew one from the other). Some people walked over to Woking to buy the meat which was sold off late on Saturday, because, of course, there was no refrigeration. There was a barber's shop and, of course, the blacksmith's.

A great many households held family prayers before breakfast. The head of the house stood near the table with the large bible in front of him. In the larger household the servants, in their aprons and caps, sat on one side of the room against the wall and the family sat on the other.

Hours, at the turn of the century, were long, wages poor and amusements self supplied, but most of the people I have spoken to seemed to have enjoyed their early life.

These are only a few of the snippets that people have told me. We would all like to hear more about Ripley and Send in days gone by, so please may we have some of your earliest memories, and those of your friends, in the villages.

Jane Bartlett.

THE BUILDINGS OF HAMPTON COURT

Notes of a Talk on 18 September by Mr Desmond FitzPatrick

Desmond FitzPatrick, a member of the Society, is an adult education lecturer at the City University of London with a special interest in the history of architecture and buildings. He also has the rare distinction of being a Citizen of London.

He has developed a special interest in the English Baroque movement, which, limited in scope as it was, nevertheless produced memorable buildings, including such examples as Blenheim Palace, Castle Howard, Seaton Delaval, Hampton Court and Greenwich. While the latter may be the greatest secular Baroque building in England, Hampton Court qualifies, in Desmond FitzPatrick's view, as the greatest and only serious Baroque palace in this country. More humble examples of the English Baroque Movement are scattered around the country and, interestingly, may be found in monuments within the parish church of St Peters, Old Woking.

Wren may be regarded as the architect par excellence associated with the English Baroque Movement and it was under his guiding hand, from 1689 to 1702, that Wolsey's erstwhile Tudor palace was transformed into its present splendour following earlier developments during the reigns of Henry VIII (Base Court/Clock Court), Elizabeth I and Charles II (Long Canal). It was with the arrival of William and Mary on the throne that under their patronage Wren began his great work of creating a palace, embodying the essential

elements of the Baroque - a splendid interplay of force and drama - and it was with William's death in 1702 that Wren effectively relinquished the task unfinished, leaving a building of mystery and dignity. The Prince of Wales and, as he later became, George II was the only Hanoverian and the last monarch to use Hampton Court. The later Victorians took the palace to their hearts and it was opened to the public in 1890. Desmond FitzPatrick described, with reference illustrations, Wren's original plans, which are available from his papers at All Souls College. The initial concept envisaged the entire removal of the existing Tudor palace, except for the Tudor Hall on one side of the Clock Court, which would form the entrance from the direction of Bushey Park (Lions Gate). This would lead into the Privy Court, a large court surrounded by the state rooms and private apartments. The lodgings of the court officials were to be arranged around two courts, including the Great Court. The Royal Entrance, from the direction of Hampton Court Bridge, was designed to lead into the Privy Court and thence through archways to the garden, affording a vista straight down the canal. The avenue from Bushey Park, part of the original plan, was intended to lead into the Great Court. The view of the palace, approaching it along this avenue, has recently been rediscovered with the felling of trees as a result of Dutch elm disease. The Diana Fountain (in actual fact Venus) was relocated to break up the uninterrupted view down the long Bushey Park Avenue.

Desmond FitzPatrick recounted the problems facing Wren in trying to implement his original plans, notably the question of providing sufficient space to fit in all the required elements, especially to meet the needs of accommodation.

However it was finally decided to build a more modest building, so that the Tudor palace was not removed as originally planned and remained largely intact. Desmond FitzPatrick went on to explain in detail the main architectural features and the necessary compromises forced upon Wren in successive revisions. He referred to the thematic pediment decoration over the porthole windows (carved by William Emmett - see also the Royal Hospital, Chelsea, and City of London churches) intended to portray William III as Hercules engaged in one of his labours: slaying the Nemean lion (representing Louis XIV). Laguerre was responsible for the window pediment painting of the labours of Hercules and the Four Seasons. He drew attention to the Privy Garden front as among the most beautiful features of the palace. He spoke of the delightfully intimate nature of the relatively small Fountain Court, conveying an impression similar to that in an Oxford college.

Illustrating several features, including the Clock Court with its Baroque colonnade and the Wolsey Apartments behind, Desmond FitzPatrick referred to the contribution made by the antiquarian architect and assistant to Wren, Nicholas Hawksmoor.

Work on the building at Hampton Court stopped in two phases; the first in 1694 when Mary, its chief proponent, died of smallpox, then in 1702 with the death of William following a riding accident. Almost all work on the exterior ceased and it remained as we see it today. The interior decorative work, on the other hand, continued.

At first the building must have presented an outlandish appearance with its sharply contrasting Tudor and Baroque styles, its uneasy mixture of brick and Portland Stone. However the passage of time and the effects of weathering have toned down the differences into a familiar and harmonious blend; this result is seen so often in this country it may almost be considered an

architectural idiom peculiar to England. At the meeting point of the two builds liberties were taken, even to the extent of truncating an oriel window - what price conservation then and what would the Historic Buildings Department have said?

Desmond FitzPatrick outlined the main features of the interior. Included amongst them of particular note is the King's Staircase, which probably typifies most people's concept of the Baroque. The superb ironwork of the balustrade is by the Huguenot, Jean Tijou (further examples of his ironwork are visible outside) and the wall and ceiling paintings, depicting the Satire of the Caesars, are the work of Antonio Verrio, with outstanding trompe l'oeil effects. The State Apartments contain a mixture of rooms, some plain and some richly decorated, as presumably originally intended. The King's Bedroom and Dressing Room contain further magnificent ceilings painted by Verrio. Grinling Gibbons was responsible for the fine carvings on the cornice and around the fireplace. The ceiling in the Queen's Bedroom was painted by Sir James Thornhill, the only great Baroque ceiling painter this country produced; his work can also be seen at Greenwich.

In closing, Desmond FitzPatrick took questions on a number of points, including access from Bushey Park via the Wilderness Gardens, the brickwork of the building, the full complement of residents at any time, ceiling painting on plaster and Wren's method of supervising his work.

In spite of a delayed start through no direct fault of the speaker, this talk was most certainly worth waiting for. Desmond FitzPatrick's erudition and knowledge, expressed with clarity, enabled the audience to share his obvious enthusiasm for this exceptional palace, which was intended to rival Versailles and which is barely a quarter of an hour's drive from Send and Ripley.

Bob Gale

BUILDINGS GROUP REPORT ON RIPLEY BAKERY
(CORNER OF HIGH STREET AND ROSE LANE)

This property has been a bakery at least since 1851. From Kelly's Directories, William Nash was named as a baker in that year. The Geale family arrived in 1853 and remained as bakers until just before the First World War. Maurice Collins followed, owning the business until after the Second World War.

The site is believed to have had much earlier associations with baking. The corner is fairly certain to have been "The Frame Plot" in Ripley (vide Newsletter No 51). In a deed dated 16 April 1699 (Guildford Muniment Room reference 94/3/36(1)), Richard Joshua of Ripley, baker, granted to Jeremiah Leggatt of Send, miller, for "three score and ten pounds ... that cottage ... lately new built called The Frame Plott".

With the kind permission of Mrs Jennifer Gorman, members of the Buildings Group looked over the building on 23 August. From this preliminary study it was seen that there are three distinct parts with that in the middle being the oldest, quite possibly the cottage of 1699 already mentioned.

The front part of the building (part 'A' on the drawing) was apparently built as one with the grocers now Richardsons Supermarket. Although the latter has had bay windows added to the upper floor, we know from a photograph taken when the bakery was owned by Geales that there were formerly flush sash windows, with Georgian brick lintels having a central keystone. These windows were similar to those still on the front and side of the bakery shop. (Vide Ripley and Send Then and Now at page 37.)

The central part of the property (part 'B' on the drawing) was much altered, probably in the early 1800's, when the third part (part 'C' on the drawing) at the rear was added. Until that time part 'B' appears to have been a small timber-framed house of three bays, the small central bay enclosing the original brick chimney. When altered, a brick front to Rose Lane was added and the West slope of the roof was raised by about three feet, facilitating the provision of upper floor windows. It is quite likely that there were none in the house as built. Whether there was an upper floor then, and if so what it might have been used for, is open to question. Certainly it is known that fully lined garret rooms were sometimes provided having no natural light, eg Hartley Antiques (vide Newsletter No 53).

The present staircase in the chimney bay was probably inserted during the alterations in the early 1800's, since access to the rooms on either side was previously obstructed by the tie beams (now partly removed). If, therefore, the upper floor had been used, it would seem that separate ladder access would have been needed for the bays on each side of the chimney bay. Upstairs in part 'B' there is considerable soot on one of the collars over the stairs. It was deduced that this was the result of a lantern being hung there over a lengthy period.

Inside the roof space a small number of the original rafters are still present. Even on those by the chimney there is no smoke blackening, confirming the view that the chimney was built with the house. Where this original roof joins the gable end of part 'A', there is evidence on the brickwork that the latter was built before the raising of the roof in part 'B'.

Part 'C', at the end of the premises, is of interest because of the bread oven on the ground floor. Although no longer used, it is in excellent condition and clearly illustrates the traditional method of baking bread. The oven occupies nearly the whole of the floor area of this part and may have been built integrally with it. There are tie-rods through the side and end walls, securing the brickwork around the oven.

The oven doors and frames are cast iron, the main door frame carrying the identity "Kemp & Sons, oven builders, 127 Stepney Green, E. London". Today the bakery produces everything with modern equipment in a separate bakehouse at the rear of the property.

The conclusions reached on the building overall are as follows:

1. Part 'B' was originally built around 1650 to 1700 (possibly the recorded cottage of that period).
2. Part 'A' was built in the late 1700's.
3. Part 'B' was altered, and part 'C' was added, possibly at the same time, in the early to mid 1800's.

John Slatford

MEDIAEVAL HOUSES IN SUFFOLK

A recent week's holiday at Clare in Suffolk prompts me to write a few lines recommending this area to members who are particularly interested in mediaeval houses dating from the early 15th century. All within easy reach of Clare are such villages as Cavendish (the site of the Ambrose vineyards and

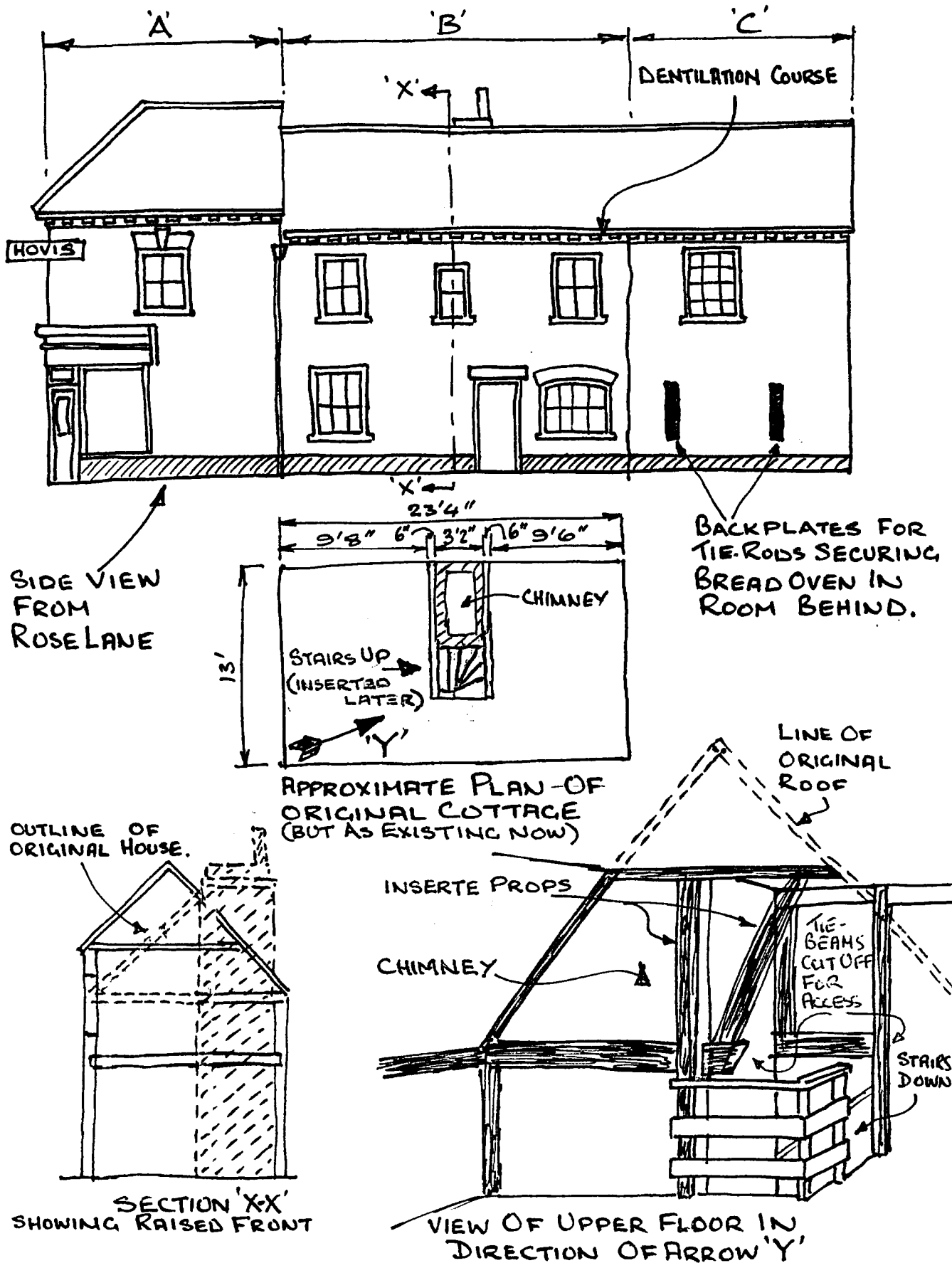

'A' = FRONT OF SHOP BUILT AS PART OF GROCERS SHOP NEXT DOOR.
 'B' = c 17th CENTURY COTTAGE, LARGELY REBUILT c 1800.
 'C' = BAKERY AREA BUILT WHEN 'B' WAS ALTERED.

RIPLEY BAKERY
ROSE LANE. RIPLEY.

SEND TO RIPLEY HISTORY SOCIETY
 SEPTEMBER 1984.

The Lordship of the Manor of Papworth

In Newsletter No. 57 a list of the Lords and their Stewards in the Manor of Dedswell, one of the ancient Manors comprising the Parish of Sand, was published. Further detail has since come to light, and a corrected list will appear shortly. In the meantime, our member John Molyneux-Child, the current Lord, has prepared a similar list for the Manor of Papworth (now known as Papercourt), and he has kindly provided us with a copy for publication as follows:

Lord of the Manor

1. William de Weston. Lord of W. Clandon M.P. (1331-1354C)
2. William de Weston. M.P. the younger, Sheriff of Surrey & Sussex (1354-1382C)
3. William de Weston. Sheriff for Surrey & Sussex in 1418
4. William de Weston. Escheator for Surrey & Sussex in 1448.
5. John de Weston M.P. (? - 1441)
6. Thomas Slyfelde of Slyfelde (1441-1471)
7. Ann Slyfelde. (widow of Thomas Slyfelde) (1471-1487)
8. Henry Slyfelde (1487 - ?)
9. John Slyfelde (? - 1531)
10. Edmund Slyfelde, Esquire. Sheriff of Surrey & Sussex (1530-1590)
11. Henry Slyfelde (1590-1598)
12. Elizabeth Slyfelde (1598-1602)
13. Edmund Slyfelde. Lord of W. Clandon (1602-1612)
14. Henry Weston, senior of Ockham. Gentleman (1612-1616)
15. Henry Weston, the younger, Esquire (1616-1638)
16. Rev. Dr. Edward Weston (1638- ?)
17. Henry Weston, Esquire. Sheriff of Surrey & Sussex in 1661 (1661C)
18. Catherine Weston. (widow of Henry Weston) X? - 1680C)
19. John Weston. Esquire. Receiver General. Sheriff of Surrey & Sussex. M.P. (1680C-1711)
20. Sir Peter King. Lord Chief Justice of the Common Bench later Lord King. Baron of Ockham & Lord Chancellor (1711-1734)
21. John 2nd Lord King (1734-1740)
22. Peter 3rd Lord King (1740-1754)
23. William 4th Lord King (1754-1767)
24. Thomas 5th Lord King (1767-1779)
25. Peter 6th Lord King (1779-1783C)
26. Rt. Hon George Lord Onslow & Cranley (1st Earl) (1783C-1814)
27. Rt. Hon Thomas 2nd Earl of Onslow (1814-1827)
28. Rt. Hon Arthur George 3rd Earl of Onslow (1827-1870)
29. Rt. Hon William Hillier 4th Earl of Onslow (1870-1911)
30. Rt. Hon Richard William Alan. 5th Earl of Onslow (1911-1945)
31. Rt. Hon William Arthur Bampfylde. 6th Earl of Onslow P.C. (1945-1971)
32. Rt. Hon Michael William 7th Earl of Onslow (1971-1984)
33. Major John Walter Molyneux-Child (1984-Present)

Steward

- John Champion. Gentleman (1612)
- John Champion. Gentleman (1616)
- George Duncomb Esquire M.P. (1639)
- { Henry Baldwyn. Gentleman (1648)
Richard Heath Esquire (1661)
Richard Heath Esquire (1667)
- { Richard Heath (later Knighted) (1682)
Sir St. John Broderick (1686)
Nathaniel Sturt. Gentleman (1699)
- Nathaniel Sturt. Gentleman (1711-1728)
- John Chatfield Gentleman (1741-1751)
- John Martyr. Gentleman (1780)
- Joseph Pickthorne Gentleman (1790-1798)
- Frederick Ferdinand Smallpeice (1873-1878)
- Brian Turner Wooding. BA (Cantab) (1984-present)

production of excellent wines), Castle Hedingham (the massive castle keep over 100 feet high dating from the 12th century has a magnificent banqueting hall with a minstrels' gallery and the largest Norman arch in Europe), Long Melford, Kersey (not visited unfortunately, but by all accounts not to be missed), Lavenham and many others, not forgetting Clare itself. The casual visitor or the student of architecture has the opportunity to enjoy what must amount to an unparalleled range of early timber-framed houses, particularly many fine early examples of jettied construction. Another feature common in this area is pargetting, ie decorated external plasterwork. All the villages mentioned are gems, but perhaps Lavenham is the jewel in the crown: standing in the market place surrounded by an astonishing homogeneity of old timber-framed buildings, with the magnificent Guildhall forming the centre-piece, creates an uncanny impression of being transported back some five hundred years - or being on a film set! Even all telegraph poles were removed in 1967 and the lines hidden underground.

The origin of many of these houses, a considerable number of which are very substantial and impressive and belonged to prosperous merchants, is associated with the woollen cloth and weaving trade which grew up here in the 14th and 15th centuries and brought vast wealth to the area. It also attracted an influx of Flemish weavers. It was said that at one time half the men in England wore tough Kersey cloth and a similar number of women Linsey-Woolsey made in the village of Lindsey.

A trip to this area could not be more highly recommended and can if necessary be made within a day, using the M11 after passing London, or taking a combination of M25 from Reigate/M11. Much better, however, to slow down to the pace of the local area and enjoy a week or two there. Being relatively flat, it is also an excellent area for easy touring by bicycle. There are many fine old churches and a remarkable number of very attractive inns was also noted.

Bob Gale

SEND TANNERY

Further to the notes on this subject in Newsletters 56 and 57, Reg Giles has provided us with further details as follows. Tom Faithfull of Send Road worked at the tannery from 1931 until 1933 when Mr Johnny Ashford ceased operating the business and sold up. The man who bought the factory started a soap making business. This did not last long and in about 1936 engineering work was started with lathe turning, drilling, etc. A Mr Docherty is believed to have run it and lived in Tannery House for some years until after the Second World War, when it was bought by Mr Hamburger. Another person who worked in the tannery for many years was a Mr Wapshott.

A PLEA FOR HELP WITH TYPING

The work of the Documentary Group has reached a stage where we need help with typing the various records that have been transcribed. We would be very pleased to hear from members able and willing to undertake some of this work.

Most of the tasks involve the baptism, marriage and burial registers, but there are a number of others where at present we have only manuscript records.

Will any volunteers please telephone me on Guildford 222107.

John Slatford

"THEN AND NOW"

The Changing Scene of Surrey Life

As most members are now aware, the book has been published on schedule and already distributed to pre-publication purchasers and retail outlets. Reaction so far has been highly favourable and all signs indicate that the book has been well received. It is especially gratifying to note that it has enjoyed an initial success locally. We are confident that this will continue and hopefully be extended into neighbouring areas. Comment has been made that there are fewer pictures of Send than of Ripley, but this is because fewer photographs and postcards of the Send area have so far surfaced. In the event of a second volume later being published, perhaps this imbalance can be righted if the necessary material is forthcoming.

We were delighted to see such a good response to the invitation to the "book launch" on Saturday, 3 November, at the Manor House at Send Marsh. In fact it was almost overwhelming, but our hosts, Anne and Les Bowerman, coped admirably. The Society is indebted to them for providing such a splendid setting and excellent hospitality for the occasion. The occasion was graced by the presence of the following guests, who are prominent in local history circles in Surrey generally, namely Matthew Alexander, Curator of Guildford Museum, Shirley Corke, archivist at Guildford Muniment Room, Liz Stazicker, on behalf of herself and Dr Robinson, the County Archivist, from Kingston, Pat Ashworth, Librarian at the Surrey Archaeological Society Library, Professor Alan Crocker, Chairman of the Surrey Industrial History Group, and Glenys, his wife, who is Editor of that Group's Newsletter, and Mark Sturley, Senior History Master at the Royal Grammar School and Guildford historian. All of these guests have been very good friends of the Society for some time and we were very pleased to have them with us. A photographer from the "Surrey Advertiser" was also present at the launch. A photograph duly appeared in the "Surrey Advertiser" in their edition of 9 November, together with a press release issued by the subcommittee responsible for the book.

Please Note: We regret that one or two faulty copies of the book have been discovered with pages missing or in the wrong order. If such books are handed back to the Society they will, of course, be replaced by perfect copies.

Bob Gale

THE ALMSHOUSE, Including Further References to

RIPLEY CHURCH and NEWARK PRIORY

In Newsletter No 58 we commented on the facts that the chancel of the church was built circa 1160, that it was referred to as a chapel or oratory in 1199, and that it, among other property, was given at the latter time to the Augustinian Canons as endowment for the Priory which was to be built and dedicated to the Blessed Virgin Mary and the Glorious Martyr Thomas.

In 1219/20 the Prior was granted by Henry III the right to hold a fair on the eve and day of St Mary Magdalen (details Manning & Bray, volume 3). Also on the eve of this saint's day the Prior was wont to make a distribution of bread, etc, to the poor of Ripley (Surrey Archaeological Collections, volume 50, quoting notes by Captain Pearce).

An early 13th century deed in the Althorpe collection (inherited by Lord Spencer's family from Sir Anthony Browne, to whom the Priory lands were granted by Henry VIII) recites the grant of a croft of land by Geoffrey Le Dine (of Dunsborough?) "in soul alms to the Hospital and Brethren of St Mary Magdalen of Reppeley".

According to the Episcopal Registers of Bishop Wykeham quoted in the VCH, volume 2, page 104, as from 1382 the Prior in certain circumstances was to distribute to the poor at the gate of the monastery (sic) three pence to pray for the souls of the founders (of a chantry in the Priory).

When pondering over the origin of the Priory, we overlooked the fact (recited in VCH volume 2 page 104) that a visitation of the Priory in 1387, instigated by Bishop Wykeham, resulted in the resignation of Prior Alexander Culmeston and the acceptance of the resignation by Robert, Prior of Merton. At the same time John Chesterton, one of the canons, was removed because of "scandalous excesses" and placed in custody at Merton.

According to Captain Pearce's notes (SAC 50), in 1616 it was attested in a lawsuit over the ownership of the chapel that both before and after the dissolution of the Priory in 1539 the householders of Ripley "had divine service said for or unto them in the said chapel by a priest or curate found by the prior", and until the dissolution there was "a little parcel of ground adjoining the chapel (and) an almshouse used for the relief of ten poor people" who were maintained there and relieved by the prior.

Under the Letters Patent of 1544, by which Henry granted the priory properties to Sir Anthony, part of the property was charged, with an annual payment of six pounds, to the curate holding office at the church or chapel of Ripley.

Edward VI' Chantry Commissioners reported in 1549 that the chapel was "builded long tyme paste for an hospitall and sythen that time altered unto whiche chappell the parochioners dwellinge nere there abought have used (for thir owne ese) to resort to here thir dyvnye servyces".

The Manorial Court Rolls of Ripley & Send contain several references to the almshouse between 1533 and 1678, and in 1709 Burley Fenn of Ripley Court bequeathed the sum of £20 to the Churchwardens of Send & Ripley towards making an addition to the almshouse.

What are we to make of these largely and apparently unconnected facts? The following suggestions are advanced.

The evidence points increasingly to Merton as the mother church of both the chapel and the priory. The dedication of Merton was to the Blessed Virgin, and this was followed for Newark with the addition of the recently martyred Thomas. (The dedication at Dorchester-on-Thames, the other possibility as mother church, was, by contrast, to the Saints Peter and Paul.)

Since the earliest references are to a chapel or oratory, we advance the theory that the original building of 1160 was intended as a wayside sanctuary or place of prayer for travellers rather than as a hospice, and the chapel association survives to this day with Chapel Farm. It may have been dedicated to St Mary Magdalen from the start, but if that were so it is surprising that there appears to be no early mention of the fact. St Mary Magdalen is most likely to have been chosen in 1219 for the fair because Ripley presumably already had a connection with this saint.

After the founding of the priory, the practice of giving to the poor soon developed and it seems from the Althorpe deed that at about the same time the use of the chapel was varied by the Prior so that it became a hospice or hospital where travellers and probably others in need in the neighbourhood were given sustenance, as is still the practice at the Hospital of St Cross at Winchester (vide NL 37), and perhaps a roof for the night and some rudimentary medical attention as well. The exact location of the hospice in relation to the surviving chancel of the original build is not known - perhaps in the body if there was one of the original building or nearby.

At all events it appears from the 1616 lawsuit, if the note is to be relied upon, that by the time of the dissolution in 1539 there was a more formal arrangement, with an almshouse on a small parcel of land adjoining the chapel where ten poor people (the Brethren) were supported by the Prior. Unfortunately the charter, assuming there was one, does not appear to have survived.

The statement in 1549 that the chapel had been "builded long tyme paste for an hospitall and sythen that tyme altered" is referring to a building which was then 400 years old and is presumably the then traditional account of the use to which it was put in the early days of the priory. "Altered" may refer to the addition in mediaeval times of a nave to the single cell of the chancel so that the "parochioners" could "here thir dyvyne servyces" in relative comfort.

What then of the almshouse? The 1616 lawsuit referred to it being on a plot adjoining the chapel prior to the dissolution. The Court Rolls confirm its existence before the dissolution and offer further clues to its location. We read that in 1533 it was opposite the copyhold tenement with garden of John Wychher. After the dissolution there are several further references to it, and the 1709 will of Burley Fenn indicates that it both continued in existence and that the churchwardens had succeeded the Prior as administrators.

As regards its location, we learn from the Roll of 1542 that the ditch of Robert Giles (of Chapel Farm), which needed scouring, extended from the almshouse at one end to Albery Grene (junction of Grove Heath Road with Portsmouth Road) at the other. In 1559 John Kyne, or Keen, who was tenant of what is now Manor House Antiques, had his property defined as being "opposite the Almshouse there". In 1590 his successor, Thomas Staunton, held a tenement and garden "at the Almshouse there". In 1605 Thomas Stanton, Senior, and John Meriot were required to place a trunk or trough (a land drain or gully? - perhaps giving rise to some of the tunnel tales) from "Chapel Lande to the Almesditch," and in 1678 James Champion of what is now the Manor House had to scour his ditch flowing into Almesditch.

So, the almshouse was on a small parcel of land adjoining the chapel. If Robert Giles's ditch extended from Albury Green to the almshouse, it must have been beside the Portsmouth Road and traces of the ditch can indeed still be seen. The almshouse, therefore, was on or near the main road. John Kyne or Keen's tenement was opposite the almshouse. Taking all the above into account, we are forced to the conclusion that it must have been where the "Anchor" now is. The 1590 reference to Thomas Staunton's tenement "at the Almshouse there" is perhaps slightly misleading. "At" in this context evidently means close to, near or by, rather than "in the same position as", because the details of the entry make it clear that it was the same property that John Keen had held.

These notes will be followed by some historical notes on the Anchor and a buildings Group report on it and the buildings associated with it.

Bette Slatford and Les Bowerman

THE HISTORY OF THE EVERSHEDE FAMILY

On Tuesday, 16 October, at Ripley Village Hall, the Society was given a most interesting talk by Mr John Dendy Evershed on his own family tree. Mr Evershed is from a West Sussex/Surrey family and his father, who was from Billingshurst, became master of Ryde House Boys' School in Ripley until he left in 1917. Dendy was the surname of his great grandmother. Mr Evershed

talked first of the quest covering the work that had gone into researching the family history, followed by the results and the conclusion from that labour.

The work had been carried out over a number of years in four phases. Phase 1 was 1865 to 1926, phase 2 1929 to 1939, phase 3 1936 to 1977 and phase 4 1977 to the present day. These phases represent the work done by the various members of the family who were interested in their pedigree, one taking over where the previous one had left off. Mr Evershed himself started in 1939.

Dendy Evershed demonstrated how, from one original family, the net had become widespread over the world, previously unknown members of that family increasing the Eversheds to thousands, from all walks of life. They were found in New Zealand, South Africa, America, Australia, Canada and many other places. Practically all known Eversheds have been found to stem from this one family. The earliest known spelling of the name is Everesshede, which is understood to mean bear's head. During the search the College of Arms was able to produce a Grant of Arms and a pedigree back to the year 1500. Some 126 Eversheds, plus a number of other relatives, are buried at the Unitarian Chapel at Billingshurst and there have been two family gatherings there in the past four years with hundreds of Eversheds coming from all over the world. Before one of his relatives died aged 93, she had passed onto Dendy what her grandfather had told her. This meant continuous recollection back to the 1700's.

When Mr Evershed finished speaking and questions were asked and answered, the audience was invited to examine the enormous number of exhibits covering the walls and tables, including family photographs, houses and the 66-foot long pedigree chart on 24 large sheets. Dendy has all the facts so much at his fingertips that when asked about any member of the family he seems able to quote from memory the exact reference on his chart.

Whilst we may not all be as fortunate as Dendy Evershed in having such a good start on the quest of family history, with a wonderful collection of invaluable handwritten notebooks going back as far as 1864, perhaps this man's achievement will encourage some of our members to start tracing their own pedigree, so that there will be a written record of their special line, to which future genealogists can refer.

Marie Timmings

SECRETARY'S REPORT

Membership

We are pleased to welcome the following new members: ...

Mrs Audrey Sykes, Kevan Cottage, Clandon Road, Send. ...
Mr & Mrs Dolland, Talbot Cottage, High Street, Ripley.
Miss D Hawkesworth, Crofters, 46 Newark Lane, Ripley...
Mrs W Ward, Flamingo, Send Hill, Send.
Mr & Mrs T Appleton, Apple Trees, 45 Send Road, Send.
Miss B M Nokes, 18 Grove Heath North, Ripley.
Mr & Mrs R Hale, 5 Church Row, Ripley.
Mr & Mrs C G Cross, Durslea Cottage, The Green, Ripley.
Mr & Mrs A MacMillan, Vintage Cottage, 17 Rose Lane, Ripley.
Mr P Rixon, 12 Rose Lane, Ripley.
Mr & Mrs B Poat, 16 Birtley Road, Bramley.

Total membership has topped 300 for the first time with 102 double and 98 single subscriptions paid.

Volunteers for Archaeological Work in Surrey

The Surrey Archaeological Society wishes to build up a list of people prepared to assist with excavations or other archaeological work in the county, especially at times during normal working hours. They have asked if any of our members would like to volunteer. If you are interested, please send a note to me at Send Manor, Ripley, giving the following details: name, address and telephone number, when available (eg weekends only; every Tuesday; one day a week; afternoons), area of availability (eg within ten miles of Send and Ripley), need for lift? Travel expenses? (Outside a certain area only?), type of work (eg excavation, field walking, initial processing, pottery etc, washing, marking, cataloguing, drawing of plans, finds, etc). Brief details of any previous experience and other comments, eg unable to carry out heavy work, should also be added. The County Archaeological Officer, David Bird, will be grateful for any help we can give. The list, when compiled, will be open to directors of archaeological work in Surrey to call on if they need extra help.

St Mary's Church, Send, Restoration Appeal Fund

An appeal fund has been launched to raise £20,000 to repair and restore Send parish church, and we have been asked if we can assist. Although this is not specifically provided for in our constitution, we have an interest in seeing the oldest building in Send properly maintained and have accordingly made a token contribution of £10. We have also promised to bring the attention of our members to this project and invite them to consider whether they can assist, either by direct contribution or by organising some special event or project to support the appeal.

The Annual General Meeting

Notice is hereby given that the 10th Annual General Meeting of the Society will be held on Thursday, 28 February, 1985, at 8 pm in Ripley Village Hall.

Items for inclusion on the Agenda must be received by me as Secretary, in writing, before 31 January.

The formal business of the evening will be followed by reports from working groups on the recent work they have been doing on the history of Send and Ripley.

Les Bowerman

FORTHCOMING EVENTS

- Wednesday, 28 November ... Buildings Group meeting at 8 pm at Little Ripley House, High Street, Ripley.
- Monday, 3 December ... Folk Memories Group meeting at 8 pm at 183 Send Road, Send.
- Friday, 14 December ... Christmas Social at 8 pm in Ripley Village Hall. Tickets priced £2.50, obtainable in advance from Ken Bourne (Guildford 223028) or other members of the Committee. There will be a Then and Now theme, and members are invited to attend in any costume current in the past one hundred years. Offers of raffle prizes to John Slatford (Guildford 222107), please.
- Wednesday, 9 January ... Main Committee meeting at 8 pm at the Manor House, Send Marsh.
- Thursday, 17 January ... Buildings Group meeting at 8 pm at Muir House, Brooklyn Road, Woking.

- Tuesday, 29 January ... Open meeting at 8 pm in the Red Cross Hall, Sandy Lane, Send, when Chris Howkins will give an illustrated talk entitled "Royal Tales of Surrey".
- Thursday, 28 February ... Annual General Meeting of the Society at 8 pm in Ripley Village Hall, followed by progress reports by the working groups on their studies of local history in Send and Ripley.
- Tuesday, 26 March ... Open meeting at 8 pm in the Red Cross Hall, Sandy Lane, Send, when the film "Tales of Old Guildford" will be shown.
- Thursday, 25 April ... Open meeting at 8 pm in Ripley Village Hall, when Mr Jack Chinn will give an illustrated talk on the History of Brooklands.

Closing Date

The closing date for the next issue of the Newsletter will be Monday, 7 January.

SYMPOSIUM OF LOCAL HISTORY

The 19th symposium organised by the Surrey Local History Council, under the Chairmanship of Kenneth Gravett, was held at Surrey University on 10 November. This was the first time that Guildford had been host to this popular annual event. Previously the venue had been Dorking.

This year's theme was "Surrey Churches". As usual there was a very good attendance and the standard of exhibits was excellent. Of particular note was the small exhibit of copies of water colours from the J & E Hassell collections by Lambeth Archives Department (see also the catalogue produced by J C Batley and G P Moss, SAS volume 75 1984). As a result of the excellent work by Batley and Moss, many societies were able to display water colours of buildings appropriate to their exhibits from this collection.

Send & Ripley History Society mounted a display of photographs showing views of Send Church, including an 1804 water colour by Henry Petrie (about whom little is known), which is the earliest known view of the church. This is reproduced in the Society's publication "Then and Now, the Changing Scene of Surrey Village Life", available from local bookshops.

An interesting programme of talks complemented the exhibits. The subject of the symposium was eloquently summarised by Dr David Robinson, Surrey County Archivist, through his learned discourse on the development of Christian churches in England between the pre-conquest to the Victorian periods. Mr Mervyn Blatch, author of several books on churches, notably "A Guide to London's Churches", Constable, treated delegates with a brisk authoritative tour around Surrey's churches, supported by excellent slides. Last but by no means least Dr Derek Renn, Chairman of Leatherhead & Bookham History Society, spoke informatively, humorously and in detail about scratch dials, a good example of just one of the many architectural appendages to English churches which make their study so intriguing.

To summarise, a good day out, an opportunity to meet friends and other societies, and it is hoped Guildford will be chosen again for this event.

K H Bourne

Editorial Note: The Society is grateful to Ken Bourne, its Chairman, for single-handedly preparing the Society's exhibit for the symposium.

... the ... of the ...

... the ... of the ...

... the ... of the ...

THE ...

... the ... of the ...

... the ... of the ...

... the ... of the ...

... the ... of the ...

... the ... of the ...

... the ... of the ...